

Magnet-Adapter XMA-...

Zur Kontaktierung von Schraubenköpfen mit starrer Ø 4 mm-Buchse im Isolierkörper, geeignet zur Aufnahme federnder Ø 4 mm-Stecker mit starrer Isolierhülse.

XMA-7



XMA-7L



XMA-11



Magnetic Adapter XMA-...

For connection of screw heads with rigid Ø 4 mm socket in insulator, suitable for mating with spring-loaded Ø 4 mm plugs with rigid insulating sleeve.

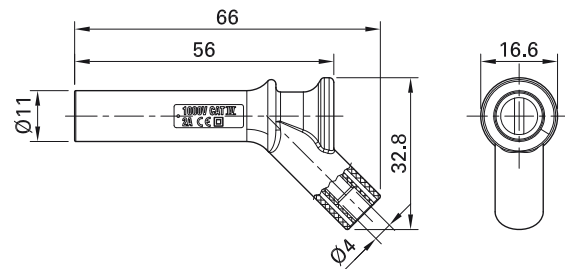
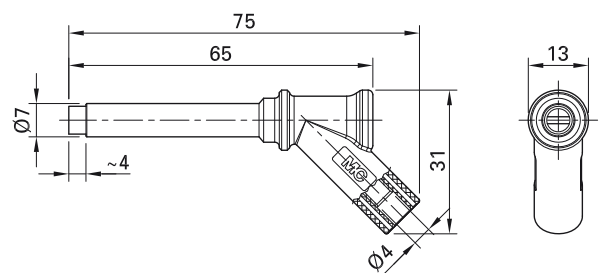
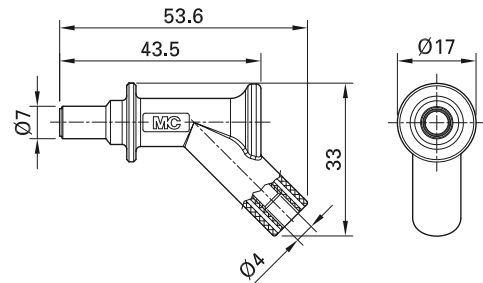

| Typ Type | Bestell-Nr. Order No. | Bemessungsspannung/-strom Rated voltage/current | Magnet-Durchmesser Diameter of magnet | | * Farben * Colors |
|-------------|--------------------------|--|--|-------|----------------------|
| XMA-7 | 66.9516-* | 1000 V, CAT III / 2 A 600 V, CAT IV / 2 A | Ø 7 mm | Ni CE | 21 22 23 |
| XMA-7L | 66.9509-* | 1000 V, CAT IV / 2 A | Ø 7 mm | Ni CE | 21 22 23 |
| XMA-11 | 66.9515-* | 1000 V, CAT IV / 2 A | Ø 11 mm | Ni CE | 21 22 23 |